

sofamel

Product Technical Specifications

Mod. AP

Insulated pin terminal

Functionality

The AP pre-insulated terminals are made with electrolytic copper strap and PVC insulation.

Raw Material Features

Insulating material of copper, vinyl, nylon.

Insulating material with flame retardant additives.

Electrical Features

For 0.5 to 1.5mm² cable the maximum current is 19A.

For 1.5 to 2.5mm² cable the maximum current is 27A.

For cable from 2.5 to 4mm² the maximum current is 36A.

For cable from 4 to 6mm² the maximum current is 48A.

Certified

They comply with the provisions established in Directive **D.C 2014/35 / EU** on electrical equipment intended for use with certain voltage limits of the Council of the European Communities.

And according to the **UNE 21021** standard: Connection parts for power lines up to 72.5 kV.

Quality tests according to **UL 486A-486B** Wire connectors Standard.

Halogen free.

They comply with European Union Directive 2015/863 / EU (**RoHS 3**).

Operating continuous temperature: 90 °C.







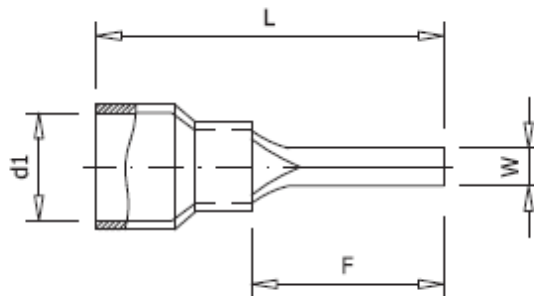

Mod. AP

Insulated pin terminal

Dimensiones



| Código | Ref. | Sección (mm ²) | Dimensiones (mm) | | | |
|--------|---------|---|------------------|------|------|-----|
| | | | W | F | L | d1 |
| 285100 | AP-1,5 |  1,5 | 1,9 | 10,0 | 20,0 | 1,7 |
| 285130 | APL-1,5 | | 1,9 | 12,0 | 21,8 | 1,7 |
| 285110 | AP-2,5 |  2,5 | 1,9 | 10,0 | 20,0 | 2,3 |
| 285140 | APL-2,5 | | 1,9 | 12,0 | 21,8 | 2,3 |
| 285120 | AP-6 |  6,0 | 2,8 | 13,0 | 27,0 | 3,4 |